

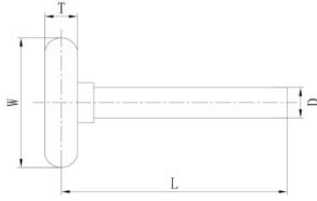

Plastic Pulley for Vans

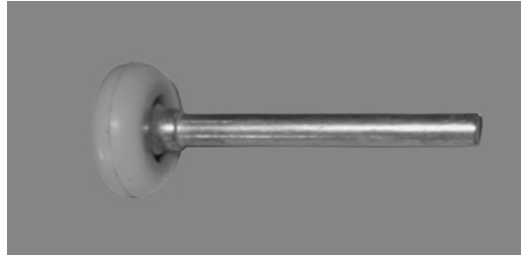

Part No	031001	031002	031003
L	83	114	114
W	47	46	46
D	11	11	12
T	12	12	12
Weight (KG)	0.112	0.115	0.115

Plastic Pulley for Vans

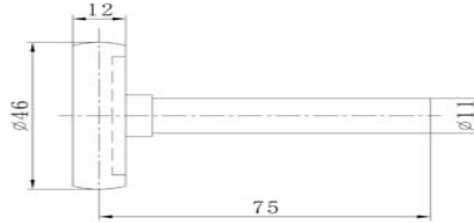

Part No:	031004
Material:	Steel
Weight:	0.176KG
Surface treatment:	Zinc plated

Plastic Pulley for Vans

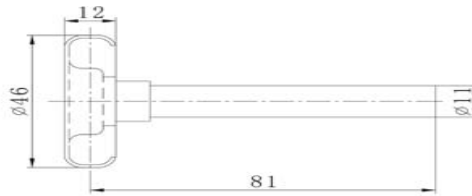
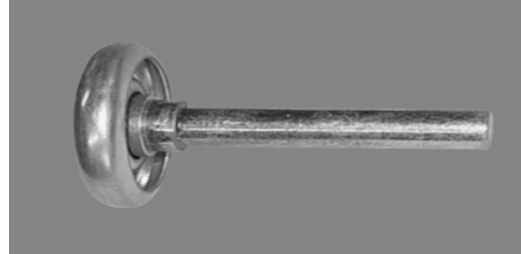

Part No:	031005
Material:	Steel
Weight:	0.128KG
Surface treatment:	Zinc plated

Plastic Pulley for Vans

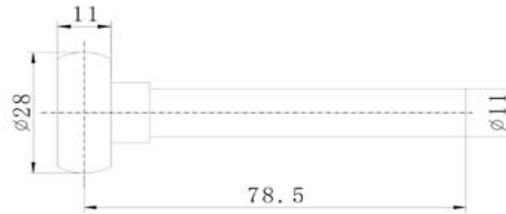

Part No:	031006
Material:	Steel
Weight:	0.098KG
Surface treatment:	Zinc plated

Plastic Pulley for Vans



Part No:	031007
Material:	Stainless steel
Weight:	0.25KG
Surface treatment:	Polished

Plastic Pulley for Vans

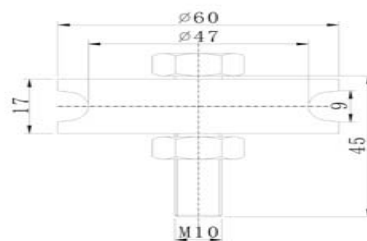

Part No:	031008
Material:	Steel
Weight:	0.288KG
Surface treatment:	Zinc plated