

## Side Door Hinges

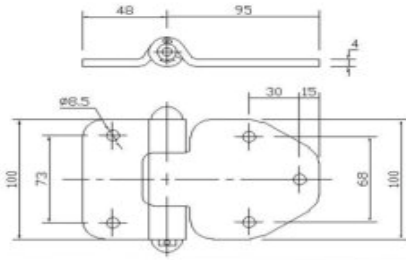

Part No. 043014/043014-In  
 Material: Steel/Stainless Steel  
 Weight: 0.458KG/0.446KG  
 Surface treatment: Zinc Plated/Polished  
 For use with the pin  
 180° opening

## Side Door Hinges

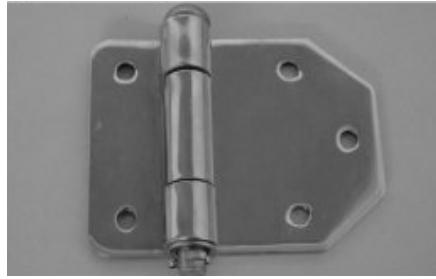
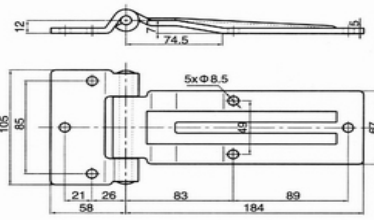
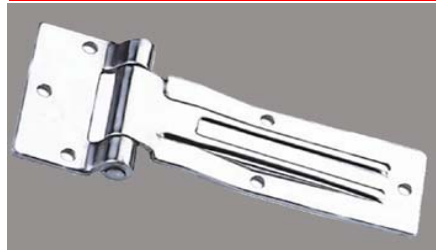

Part No. 043015/043015-In  
 Material: Steel/Stainless steel  
 Weight: 0.326KG/0.316KG  
 Surface treatment: ZincPlated/Polished  
 For use with the Pin  
 180° opening

## Side Door Hinges

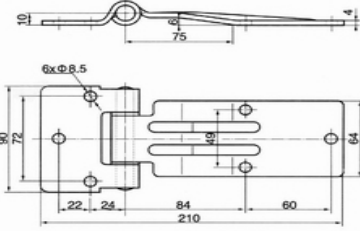

Part No. 043016/043016-In  
 Material: Steel/Stainless steel  
 Weight: 0.336KG/0.366KG  
 Surface treatment: ZincPlated/Polished  
 For use with the oil cup  
 180° opening

## Side Door Hinges

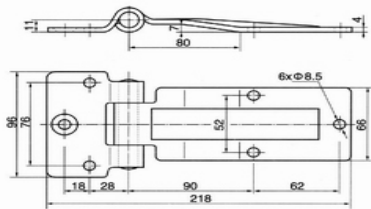

Part No. 043017/043017-In  
 Material: Steel/Stainless steel  
 Weight: 0.336KG/0.366KG  
 Surface treatment: ZincPlated/Polished  
 For use with the Pin  
 180° opening

## Side Door Hinges

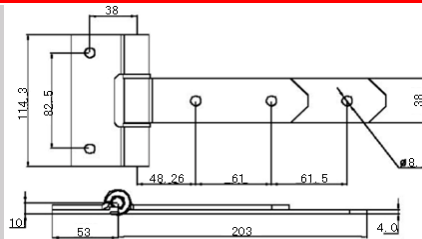
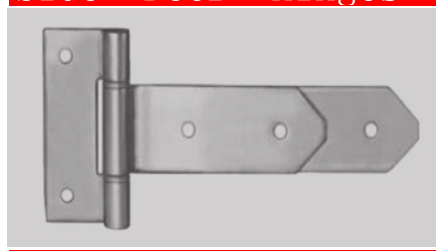

Part No. 043018/043018-In  
 Material: Steel/Stainless steel  
 Weight: 0.504KG/0.514KG  
 Surface treatment: Zinc Plated/Polished  
 For use with the Pin  
 180° opening

## Side Door Hinges

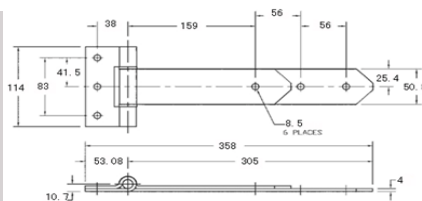

Part No. 041019/043019-In  
 Material: Steel/Stainless steel  
 Weight: 0.416KG/0.4KG  
 Surface treatment: ZincPlated/Polished  
 For use with the Pin  
 180° opening