

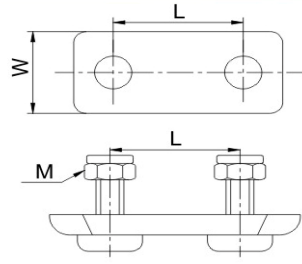

Overcenter Buckle



| Item No | M | W | L | Weight |
|---------|---|----|----|---------|
| 023101 | 6 | | 28 | 0.022KG |
| 023102 | | 20 | 28 | 0.013KG |
| 023103 | 6 | | 40 | 0.026KG |
| 023104 | | 20 | 40 | 0.016KG |

Material: Steel/Stainless steel/Plastic
Surface treatment: Zinc plated/Polished

Overcenter Buckle

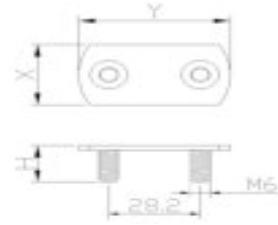
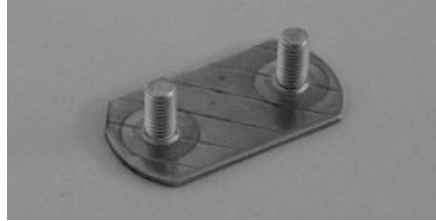

| Item No | X | Y | H | Weight |
|---------|----|------|----|---------|
| 023105 | 25 | 55 | 15 | 0.034KG |
| 023106 | 20 | 45.2 | 15 | 0.028KG |
| 023107 | 25 | 46 | 15 | 0.025KG |
| 023108 | 25 | 50 | 15 | 0.025KG |

Material: Stainless steel
Surface treatment: Polished

Cam Buckle

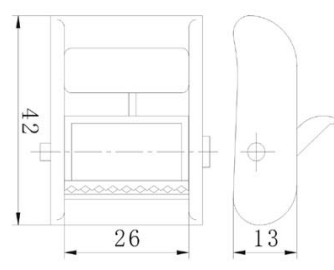

| | |
|--------------------|-----------------|
| Part No: | 023201 |
| Material: | Aluminium alloy |
| Weight: | 0.046KG |
| Surface treatment: | Oxide coating |
| Breaking Load: | 250KG |

Cam Buckle

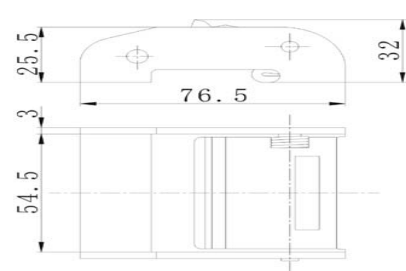

| | |
|--------------------|-------------|
| Part No: | 023202 |
| Material: | Steel |
| Weight: | 0.235KG |
| Surface treatment: | Zinc plated |
| Breaking Load: | 900KG |

Cam Buckle

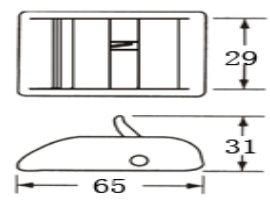
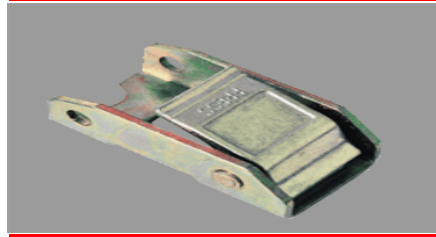

| | |
|--------------------|--------------------|
| Part No: | 023203 |
| Material: | Steel |
| Weight: | 0.135KG |
| Surface treatment: | Yellow zinc plated |
| Breaking Load: | 500KG |

Cam Buckle

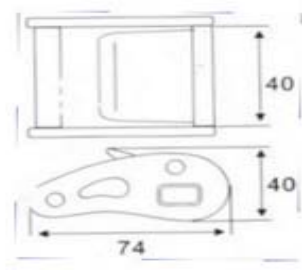

| | |
|--------------------|-----------------|
| Part No: | 023204 |
| Material: | Aluminium alloy |
| Weight: | 0.046KG |
| Surface treatment: | Oxide coating |
| Breaking Load: | 400KG |