

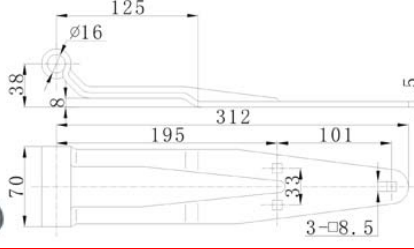

Rear Door Hinges



Part No.	041006
Material:	Steel
Weight:	0.888KG
Surface treatment:	Zinc Plated
For use with the bracket. See section Two, item 2. 270° opening	

Rear Door Hinges

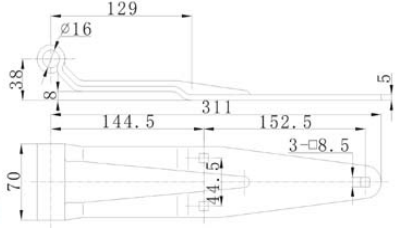

Part No.	041007
Material:	Steel
Weight:	0.82KG
Surface treatment:	Zinc Plated
For use with the bracket. See section Two, item 2. 270° opening	

Rear Door Hinges

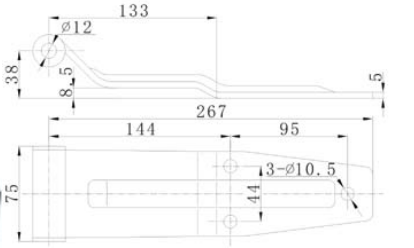

Part No.	041008
Material:	Steel
Weight:	0.756KG
Surface treatment:	Zinc Plated
For use with the bracket. See section Two, item 2. 270° opening	

Rear Door Hinges

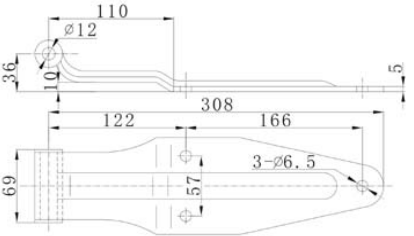

Part No.	041009/041009-In
Material:	Steel/Stainless steel
Weight:	0.998KG/0.805KG
Surface treatment:	Zinc Plated/Polished
For use with the bracket. See section Two, item 2. 270° opening	

Rear Door Hinges

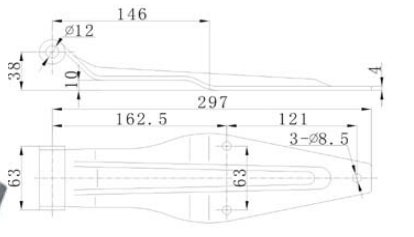

Part No.	041011/041011In
Material:	Steel/Stainless steel
Weight:	0.708KG/0.688KG
Surface treatment:	Zinc Plated/Polished
For use with the bracket. See section Two, item 2. 270° opening	

Rear Door Hinges

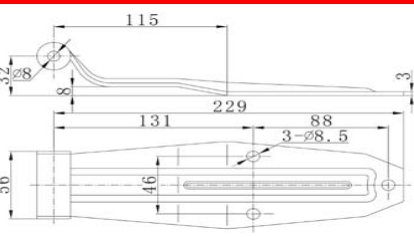

Part No.	041012
Material:	Steel
Weight:	0.372KG
Surface treatment:	Zinc Plated
For use with the bracket. See section Two, item 2. 270° opening	

TEL: +86 21 56685622 FAX: +86 21 66519637
 E-mail: truckbodyfittings@gmail.com
 WEB: www.truckbodyfittings.com